

1. EHS Safety Orientation Quiz
2. All construction personnel must wear PPE when in work area
3. Construction site must be properly cordoned off and pathways accessed must be protected to prevent damage to existing flooring or walls.
4. Provide Safety Data Sheet for materials to be used
5. Keep construction noise/vibration and dust pollution to a minimum
6. Inform us if you need large garbage bins
7. Construction personnel must use freight elevators 5, 6 & 9 only
8. All UHD-EHS hot work permits must be applied for 5 days before task is to be done
9. Enforce all tag in/out procedures concerning Electrical and Mechanical work areas
10. Vehicles parked in FM parking Bay 6, 7 & 8 are required to have logos.
11. FM bay parking is available on a first come first serve basis
12. Drivers of parked vehicles must sign in at the FM S101 Front desk with Corey Austin
13. Construction personnel must have their company ID
14. All construction personnel must sign in/out with Corey at the Front desk
15. Weekday UHD-FM working hours are: 7am – 5pm
16. Any personnel work on off-hours or weekends must submit their names to UHD-FM the day before commencing work
17. Personnel working on weekends must sign-in/out at the Police Station to make their presence known.

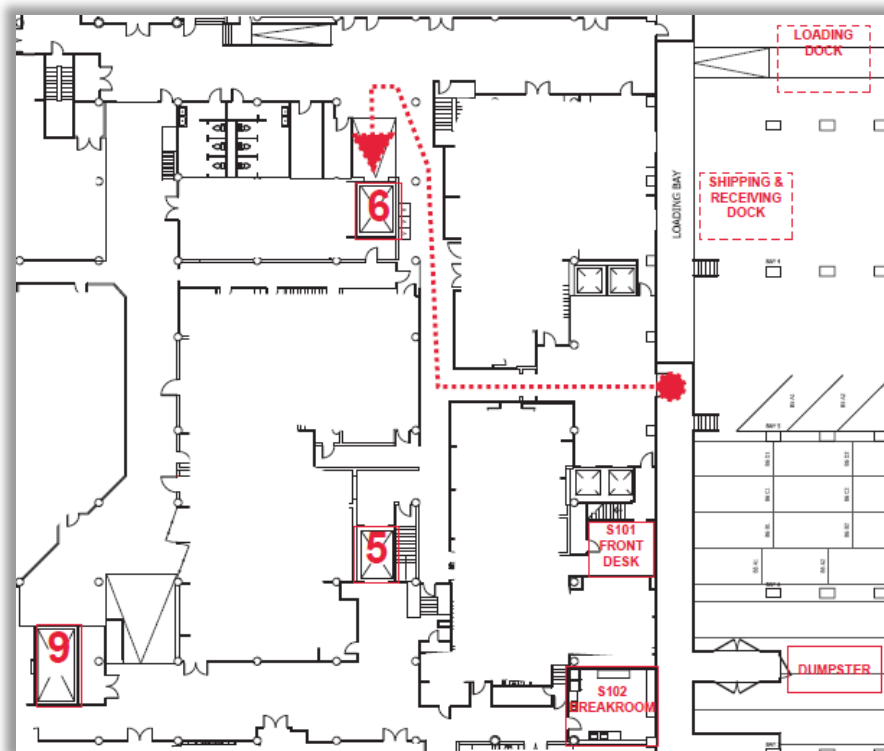

**PM Contact:**

Funke Jacob: [ogunleyeol@uhd.edu](mailto:ogunleyeol@uhd.edu)

Martin Marquez: [marquezm@uhd.edu](mailto:marquezm@uhd.edu)

Front Desk: 713-221-8026

Revised 01-20-22

